

INTRODUCTION

BCEP is working on behalf of Steeton-with-Eastburn Parish Council to draw up a masterplan for Eastburn Playing Field.

We are aware from previous consultations that people whose homes overlook the playing field are concerned about developing the use of the field.

We drew up a consultation for the residents of Sun Street and some other houses that are adjacent to or overlook the playing field, asking what they value and what they dislike about the field and some tick box questions regarding concerns they may have about development for further use.

On 23rd April 2008 James Sleigh, Karen Elliott, Gill Wood and Alison Ridler from BCEP knocked on doors, speaking to residents and recording their views or leaving the questionnaire for people who were not at home.

49 questionnaires were delivered.

James and Alison spoke to seven people living on the odd numbered side of Sun Street and residents of three other houses.

Karen and Gill spoke to three people living on the even numbered side of Sun Street and residents of two other houses.

We have received 24 responses – twelve questionnaires were filled in on the day, twelve have been returned in the post.

As expected we had more replies from the odd numbered houses on Sun Street (ten from twenty two) and the other houses adjacent to the playing field (seven from nine) as they are more directly affected by what may happen to the playing field.

We had seven replies from the even numbers on Sun Street, two of them to say that they did not feel particularly affected by what might happen.

The detailed results of the consultation are attached as appendices.

A quotation from one of the replies: 'I am all for a revitalised park, as it is looking tired at present, but the accepted development would have to take all the above questions into consideration or it will fail.'

FINDINGS

The first two questions were an undirected opportunity for people to express what they value and what they dislike about the playing field.

Question 1. What do you value about the Playing Field and the area to the rear of your home?

The views (8) and the big open space (8) are much appreciated. It is a natural green space (1). Also valued is that there are no houses there so there is privacy and that it will not be built on (2).

It is a safe area for children to play in (7). The playground is there (3). It is a children's play park in the village (1). Three older ladies said they liked to see the children playing.

Teenagers can play football and cricket (5). There is a football pitch (4) with goalposts.

It is good to see people using it (2).

Older people can meet there and enjoy the sun in peace.

It is peaceful and quiet.

The area around the edges is good for picnics.

The 'wooden assault course' ie trim trail is liked.

Question 2. What do you dislike about the Playing Field and the area to the rear of your home?

The greatest dislike was of groups of teenagers and bigger children congregating (10) and teenagers hanging around in the play area (1). More specifically, one mentioned children drinking. Two had concerns about anti social behaviour (2). Others said that this had been a problem in the past but that it less of a problem now (2).

Noise can be a problem at night, both from the pub and from groups on the playing field (5).

The area can attract undesirables and there has been camping on the field (3).

There is a lack of police attendance or other supervision (3).

Rubbish (7), dogs and dog mess are a concern (5). Broken glass in the playground (3) means it is not always safe for children to play there.

The wall beside the field needs attention (5), as does that at the bottom of the Playing Field, behind the pub (2).

There is lack of maintenance by the council (or anyone else) (5).

The football pitch is waterlogged (5). The grass is not cut often enough (2).

There is a poor and limited choice of play equipment. There is not enough play equipment for younger children (4) or for a range of ages. The play equipment is dated (2).

There is a general lack of facilities (3).

RESPONSES TO NEIGHBOURS' QUESTIONNAIRE

Question 3. What are your concerns about the Playing Field being developed for future use?

Please tick the boxes against the issues relevant to yourself, and feel free to give more detail in the space next to each.

Attracting undesirable youngsters in the evening was the greatest concern (18)

Extra need for parking on Sun Street by users of the Playing Field is a concern (16)

If a bike trail were to be installed the following were seen equally as potential concerns:

- incidents involving trials bicycles on the playing field (16),
- incidents involving trials bicycles exiting on to Sun Street (16)
- improper use of trials bicycle area (16).

Increased litter is seen equally as a potential problem (16).

Increased noise, especially at night was the least ticked, but still high (14)

More general comments from this part of the questionnaire

Two people mentioned lack of general use of the playing field though this does not seem to be a concern on the whole.

Four people said there was nothing they dislike, another that there was nothing in particular but that the whole area could do with an update.

There is a safety issue with children following balls over the wall behind the pub into the path of cars either in the pub car park or further i.e. into the main road. It might help if there was a fence on the field side of the wall behind the pub.

It has been suggested that the playground be moved further up the field so that it is further away from the main road and houses. Also that it be fenced off and clearly intended for the use of young children.

More play equipment would be welcome such as slides, a climbing frame, swings.

There is a lack of facilities for teenagers in the village, thus they hang around in gangs on the play area and in the village itself. It is important to provide facilities for them as well as younger children on the playing field.

More patrols (2), a Park Warden and regular Neighbourhood Forums could address the issues around anti social behaviour.

The full size of the football pitch can be seen as a waste of space as only a small part of it is used at any one time (1).

Previously tree planting has been proposed beside the wall. They would not be welcome – they would obscure the view.

The existing trees need attention.

It was mentioned that historically there has been drug use in the area but this seems to have stopped, though needles have been found (2). One of the street cleaners said he has found needles but not in the past two years.

The results are listed in the following tables.

WHAT IS VALUED ABOUT THE PLAYING FIELD

Question 1. What do you value about the Playing Field and the area to the rear of your home?

VALUE	NUMBER
The views	8
It is a big, open space	8
It is a safe area for children to play in	7
Teenagers can play football and cricket	5
There is a football pitch	4
Like to see children playing	3
The playground is there	3
There are no houses and it will not be built on	2
It is good to see people using it	2
It is a place where older people can meet and sit and enjoy the sun in peace	1
It is peaceful and quiet	1
Wooden assault course	1
Area around edges for picnics	1
A natural green space	1
A children's play park in the village	1

WHAT IS DISLIKED ABOUT THE PLAYING FIELD

Question 2. What do you dislike about the Playing Field and the area to the rear of your home?

DISLIKE	NUMBER
Teenagers and bigger children, groups hanging about	11
Rubbish, broken glass and litter	7
Lack of maintenance by the council	5
Wall beside ground needs attention	5
Dogs and dog mess	5
Water logging of football pitch	5
Noise, from pub and groups on the field	5
Not enough play equipment for younger children	4
Nothing about the Playing Field is disliked	4
Area can attract undesirables and there has been camping	3
Lack of police or other supervision	3
Lack of facilities	3
Glass in the playground	3
Grass not cut often enough	2
Wall at bottom end of Playing Field (behind pub) needs attention	2
Lack of use	2
Play equipment is dated	2
Pub users	1
Nothing in particular disliked but it could do with an update	1

RESPONSES TO NEIGHBOURS' QUESTIONNAIRE

re EASTBURN PLAYING FIELD

Question 3. What are your concerns about the Playing Field being developed for future use?

Please tick the boxes against the issues relevant to yourself, and feel free to give more detail in the space next to each.

CONCERNS	Sun Street odd numbers	Sun Street even numbers	Others	TOTAL
Increased noise, especially at night	6	4	4	14
Attracting undesirable youngsters in the evening	8	6	4	18
Increased litter	8	3	5	16
Parking by users of Playing Field on Sun Street	9	4	3	16
Incidents involving trials bicycles on playing field	9	3	4	16
Incidents involving trials bicycles exiting onto Sun Street	9	4	3	16
Improper use of trials bicycles area	8	4	4	16
TOTAL NUMBER OF REPLIES	10	7	7	24
TOTAL NUMBER OF QUESTIONNAIRES DELIVERED	22	18	9	49

TRIAL BIKE PARK

Comments about the trial bike park have been extracted from the additional concerns people were invited to identify as strong feelings about it were expressed.

7 people stated they are totally against the idea.

4 people have concerns but are not totally against it.

Parking and traffic issues were raised in addition to ticking the box in the questionnaire (6) and the increased risk of accidents.

Also there are concerns that if there were more bicycles in the area it would compromise the safety of small children and older people.

Bicycles might not keep to the trail, potentially endangering smaller children or elderly people (2). Motor bikes may come and use the trail (2).

Who would be liable if there were a bike trail and there was an accident?

What of damage to cars?

There is concern that that it is not for local children (2) and that there could be conflict between local children and those who come in to use the bike trail (2).

It is seen as being wanted by children from outside the village who will grow up and lose interest in it.

The existence of a trail bike park would encourage more young people into the area which might well exacerbate the problems that exist already.

The future is being decided by people not living in Eastburn.

One person said that previously it has been presented that 'You will have a trial bike park or nothing'.

The comments are listed in the table opposite.

TRIAL BIKE PARK

These opinions have been extracted from the additional concerns people were invited to identify as part of the questionnaire.

The trial bike park came up so many times it is useful to tabulate that specific information.

OPINION	NUMBER
Totally against the idea	7
Have concerns as opposed to being totally against it	4
Parking/traffic (additional comments as well as 'tick box')	6
It is not for local children	2
There could be conflict between local children and those who come to use the bicycle trail	2
It may attract motor bikes	2
Bicycles might not keep to the trail, perhaps endangering smaller children or elderly people	2
Attracting extra teenagers/undesirables	2
Who will supervise it?	2
It could exacerbate the problems which already exist	1
Increased risk of accidents on the road	1
Trials bikes might be ridden in other areas around Sun Street	1
Seen as being wanted by children from outside the village who will grow up and lose interest in it	1
Future being decided by people not living in Eastburn	1
Perception that previously it has been presented that either a trial bike park will be built or nothing will be done	1

Trial bikers carried out a demonstration of what they do and the type of terrain they like to use to Jana Bicanova, Karen Elliott and James Sleigh (photographer) from B CEP Urban Design on 11th February, 2008. They also supplied sketches, which are included in this section, of trial bike areas they would like to use on the Playing Field





SKETCH OF OPTION A FOR PROPOSED TRIALS BIKE AREA BY MEMBERS OF TRIALS BIKE CLUB

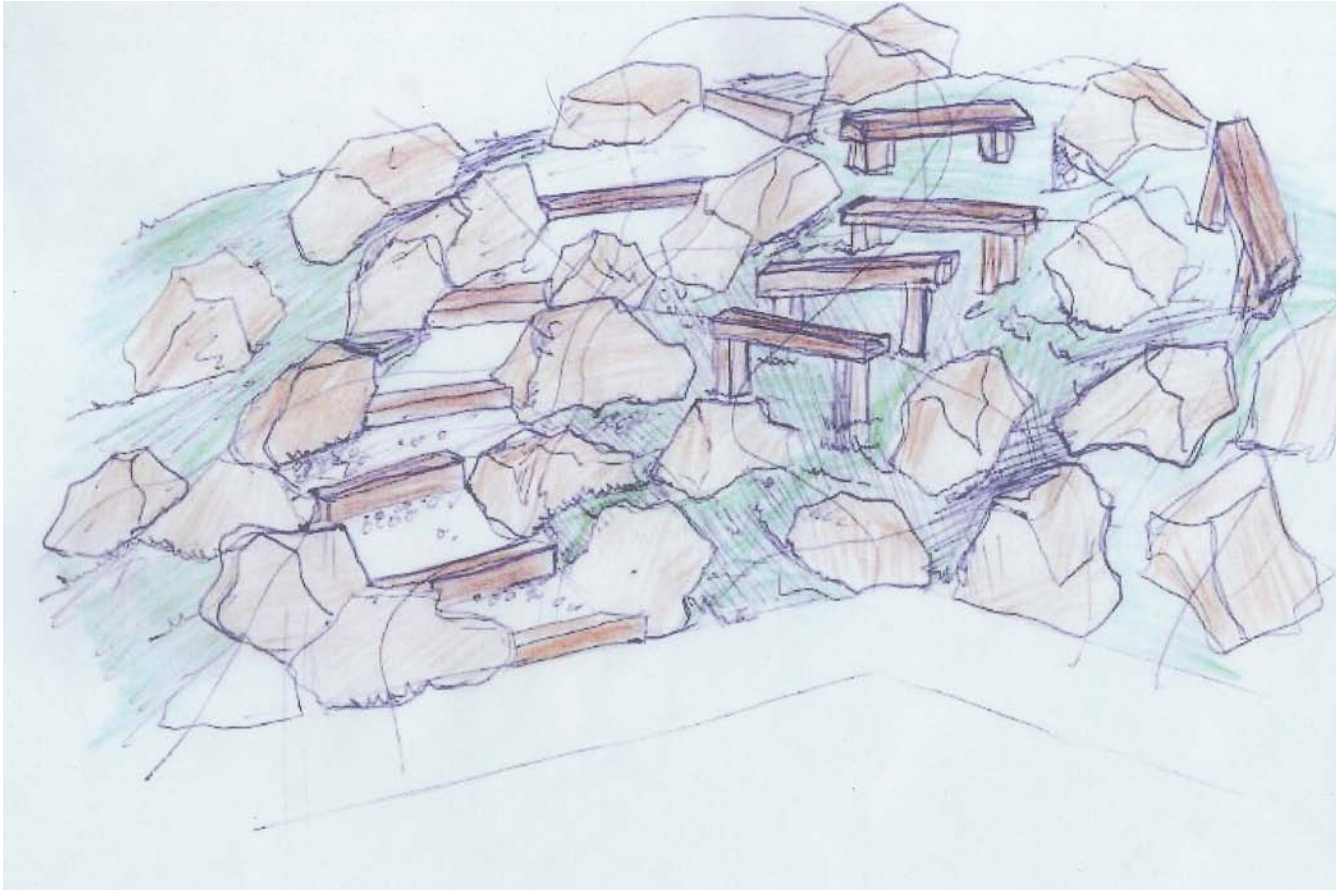

SKETCH OF OPTION B FOR PROPOSED TRIALS BIKE AREA BY MEMBERS OF TRIALS BIKE CLUB

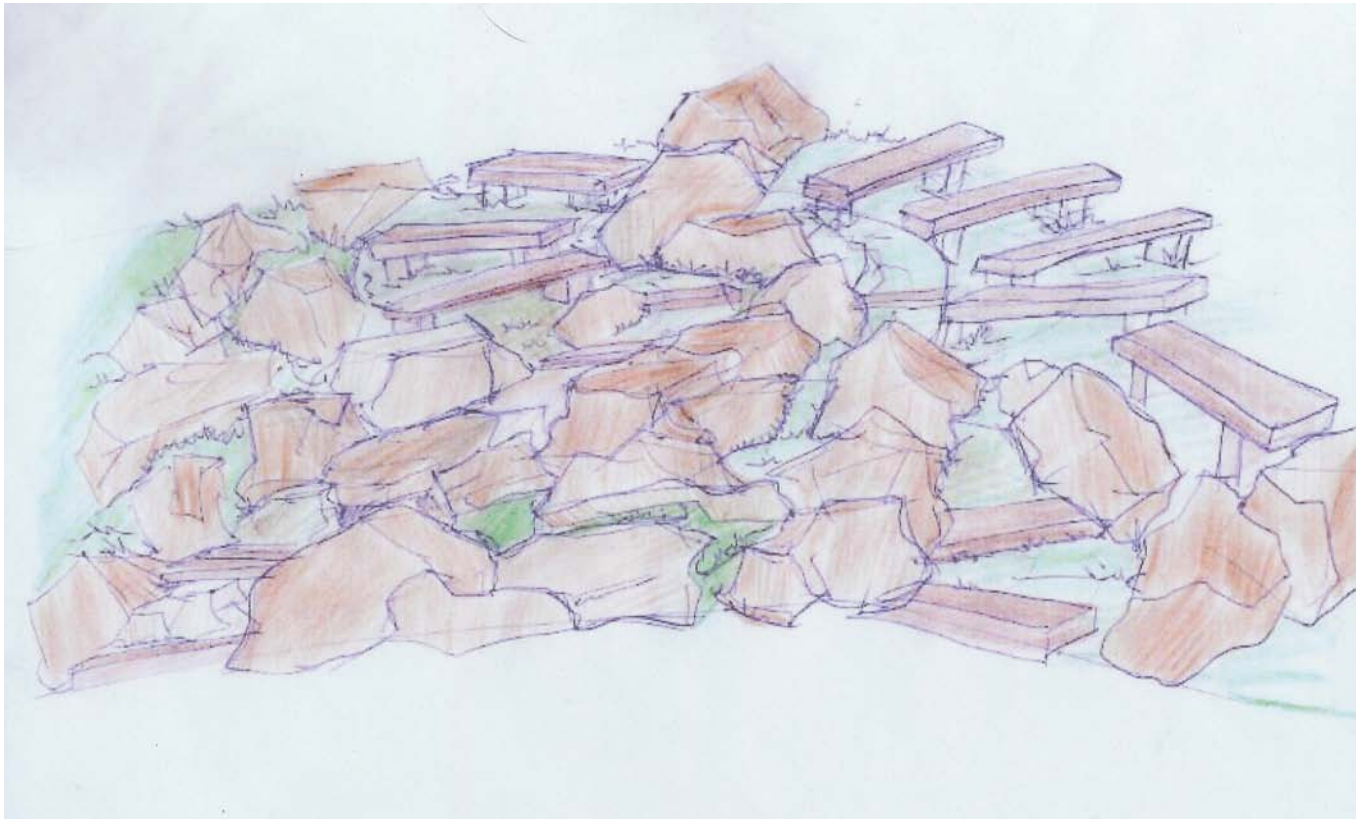

SKETCH OF OPTION C FOR PROPOSED TRIALS BIKE AREA BY MEMBERS OF TRIALS BIKE CLUB

EASTBURN JUNIOR AND INFANTS SCHOOL

Following a visit to Steeton Park on 22nd May, 2007 the children from Year Six at Eastburn Junior and Infants School did project work, in conjunction with Bradford Metropolitan District Council Parks and Landscapes department, looking at what had been their favourite pieces of play equipment at Steeton and what they would like to see at the Playing Field at Eastburn.

The children were very impressed with the bigger play equipment they had seen at Steeton and looked at items in catalogues from makers of play equipment

The 'Everest', a combination of towers, tube slides, walkways and climbing nets 'looks fun for all ages'.

There is a Climbing Ledge on which 'people can improve on their climbing'

An Adventure Trail was liked 'because it has a lot of variety'

The Shuffle Bars, used to hang from and walk using hands, 'look fun and unusual'.

They liked the Pendulum Swing with a nest seat 'because most people fight over the swings and you can sit with your friends' and 'it can fit lots of people and you don't really get swings like that and it looks fun'.

They liked the Tyre Swing because 'it's a different kind of swing'

The Double Space Net was picked out too. They had seen one at Steeton Park.

The roundabout was popular 'because you can make it go really fast'

One of the children's projects said 'We don't want anyone to be left out – perhaps a roundabout for wheelchair users/pushchairs so they could play too'.

The children didn't like the way the safety surface had been ripped up.

FIRST CHOICE PIECE OF PLAY EQUIPMENT AT STEETON

ITEM	NUMBER
Spiders Web	14
Roundabout	8
Swings	2

SECOND CHOICE PIECE OF PLAY EQUIPMENT AT STEETON

ITEM	NUMBER
Roundabout	12
Spider Web	6
Swings	4
Slide	2
All Weather Pitch	1

IDEAS FOR THE PLAYING FIELD AT EASTBURN

from a survey one of the children had done

ITEM	NUMBER
Zip wire	13
See saws	8
Tyre swing	5
Boating lake	5
Skate park	3
Mini golf	2
Picnic tables	2
Football court	2
Swings	2
Colourful	2
Paddling pool	1
Goal posts	1
Train	1
Go karts	1
Climbing wall	1
Bumps	1
Water fountains	1
Toilets	7
Shelters	1
Bins	1
Signs	1

MEETING WITH EASTBURN RECREATION YOUTH GROUP

On 1st April, 2008 Jana Bicanova, James Sleigh and Alison Ridler from BCEP met Joanne Stokes, the youth Group leader and four members of the Youth Group, girls aged 12-15 on site at Eastburn Recreation Ground.

We asked them some questions regarding the site:

1. What do you generally think of the site?

Boring/Dull

2. Do you use the site?

Mainly in the summer to meet up and to use the trim trail.

Lads play football when the pitch is dry enough.

The swings are the main piece of play equipment used, they would like to see more swings as currently there are only two.

3. How often do you use the site?

Occasionally in the winter months, more often in the summer.

4. What would make you use the site more often?

Better facilities including:

- More seats that don't give you splinters!
- Better, updated play equipment
- Spinning discs
- More swings
- Extended trim trail
- Tyre swings, BIG ones
- Improved sports pitch
- A shelter

5. Do you feel safe on the site?

Yes, in general.

Other points:

- Motorcycles aren't an issue on site as they tend to go on the moors.
- The cut through to the new houses is used but the landowner is not happy about it. It is thought it may be built on eventually.
- If the pitch was made smaller there would be more room for play equipment.